



CB 1-w with solar array (background)
and CB 8 wall or pole mount models

HIGH-EFFICIENCY PHOTOVOLTAIC MODULE

Using silicon nitride multicrystalline silicone cells, the high-efficiency photovoltaic array is standard on the **Code Blue CB 1-w** and an option on the **CB 8**. Solar is an excellent alternative when other power options are not available or if interrupted power is a concern. Code Blue incorporates Intelligent Power Management™ (IPM) to monitor the available solar energy and adjust the system to provide optimal emergency response.

With both models, Code Blue also integrates the IP Wireless interface to provide a “no power, no trench” solution for a self contained-stand alone emergency communication system.

SOLAR ARRAY FEATURES & SPECIFICATIONS

PERFORMANCE

- ▶ Half-duplex speakerphone
- ▶ Rated Power (P_{max}): 125W
- ▶ Power Tolerance: $\pm 3\%$
- ▶ Nominal Voltage: 12V
- ▶ Limited Warranty¹: 25 years

CONFIGURATION

- ▶ Clear universal frame and standard J-Box

ELECTRICAL CHARACTERISTICS²

- ▶ Maximum Power³ (P_{max}): 125W
- ▶ Voltage at P_{max} (V_{mp}): 17.4V
- ▶ Current at P_{max} (I_{mp}): 7.2A
- ▶ Warranted Minimum P_{max} : 121.3W
- ▶ Short-circuit Current (I_{sc}): 8.1A
- ▶ Open-circuit Voltage (V_{oc}): 22.0V
- ▶ Maximum Series Fuse Rating: 20A
- ▶ Maximum System Voltage: 600V (US NEC rating)

¹ Array Warranty: 25-year limited warranty of 80% power output; 12-year limited warranty of 90% power output; 5-year limited warranty of materials and workmanship. See your local representative for full terms of these warranties.

² These data represent the performance of typical CB solar panel arrays, and are based on measurements made in accordance with ASTM E1036 corrected to SRC (STC).

³ During the stabilization process that occurs during the first few months of deployment, array power may decrease by up to 3% from typical P_{max} .

PHYSICAL CHARACTERISTICS

Height	26.5" (674 mm)
Width	59.4" (1510 mm)
Depth	1.97" (50 mm)
Weight	26.5 lbs. (12.0 kg)

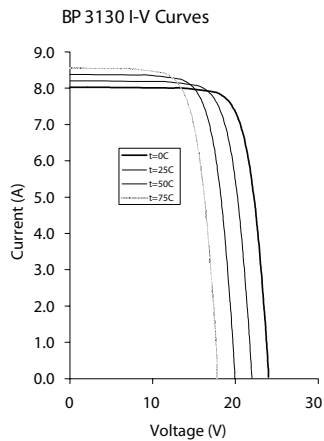

MECHANICAL CHARACTERISTICS

Solar Cells	36 cells in a 4 x 9 matrix connected in series
Junction Box	J-version junction box with 6-terminal connection block; IP 65, accepts PG 13.5, M20, 1/2" conduit, or cable fittings accepting 6-12mm diameter cable. Terminals accept 2.5 to 10mm (8 to 14 AWG) wire.
Diodes	IntegraBus™ technology includes Schottky by-pass diodes integrated into the printed circuit board bus
Construction	Front: High-transmission 1/18" (3mm) tempered glass Back: Polyester Encapsulant: EVA
Frame	Clear anodized aluminum alloy type 6063T6 Universal frame; Color: Silver

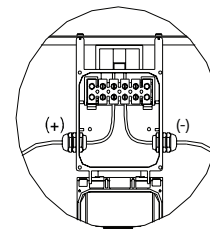
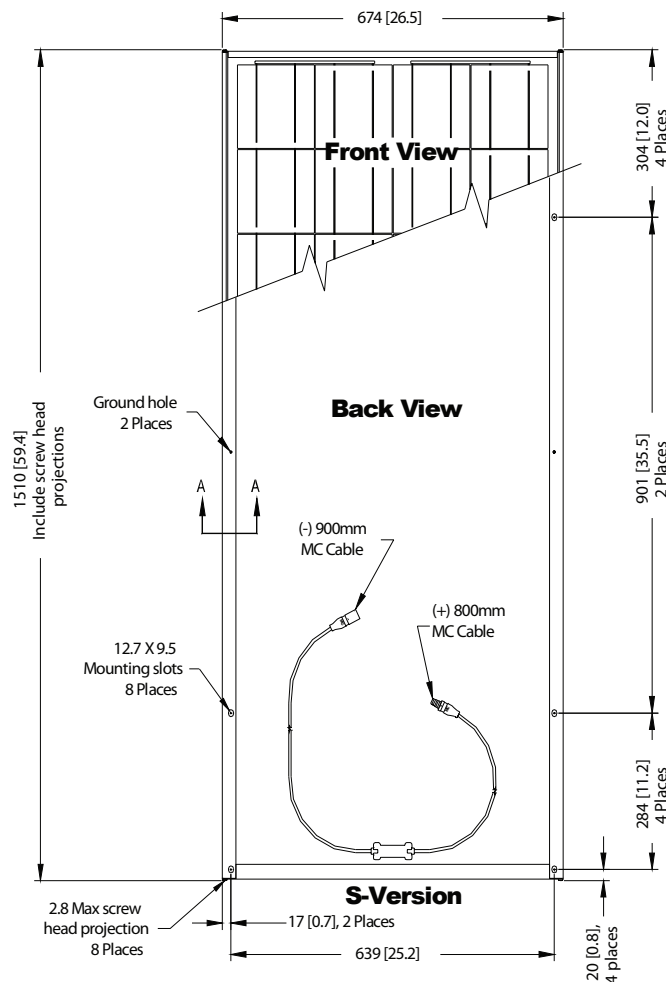

J-Version

Top View (Lid open)

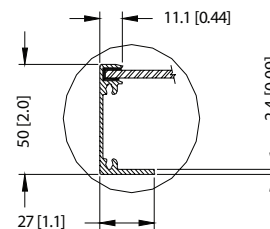

Section A - A

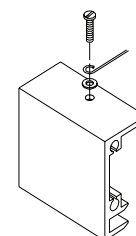

Grounding Detail

Dimensions in brackets are in inches. Un-bracketed dimensions are in millimeters. Overall tolerances ±3mm (1/8").